

BUMPERS

33 THROUGH 86 SERIES

CONTENTS OF SECTION 14

Subject	Page	Subject	Page
FRONT BUMPER	14-1	BACK-UP LAMPS	14-5
PARKING LAMPS	14-3	LICENSE LAMP	14-6
REAR BUMPER	14-3	FUEL FILLER DOOR	14-6
BUMPER MOLDING	14-5	TORQUE SPECIFICATIONS	14-6

BUMPERS

FRONT BUMPER

Removal (Figs. 14-1 & 14-2)

Disconnect both parking lamps. Remove bolts securing bumper brackets to frame and remove bumper assembly. In addition, on 52 through 86

Series, it will be necessary to detach the lower radiator rubber seal from the bumper.

Installation

To install, reverse the removal procedure. Align the bumper horizontally and laterally so that bumper to body clearance is the same on both ends. The bumper brackets and frame bolt holes are elongated providing a means of alignment. Torque bolts are indicated under TORQUE SPECIFICATIONS.

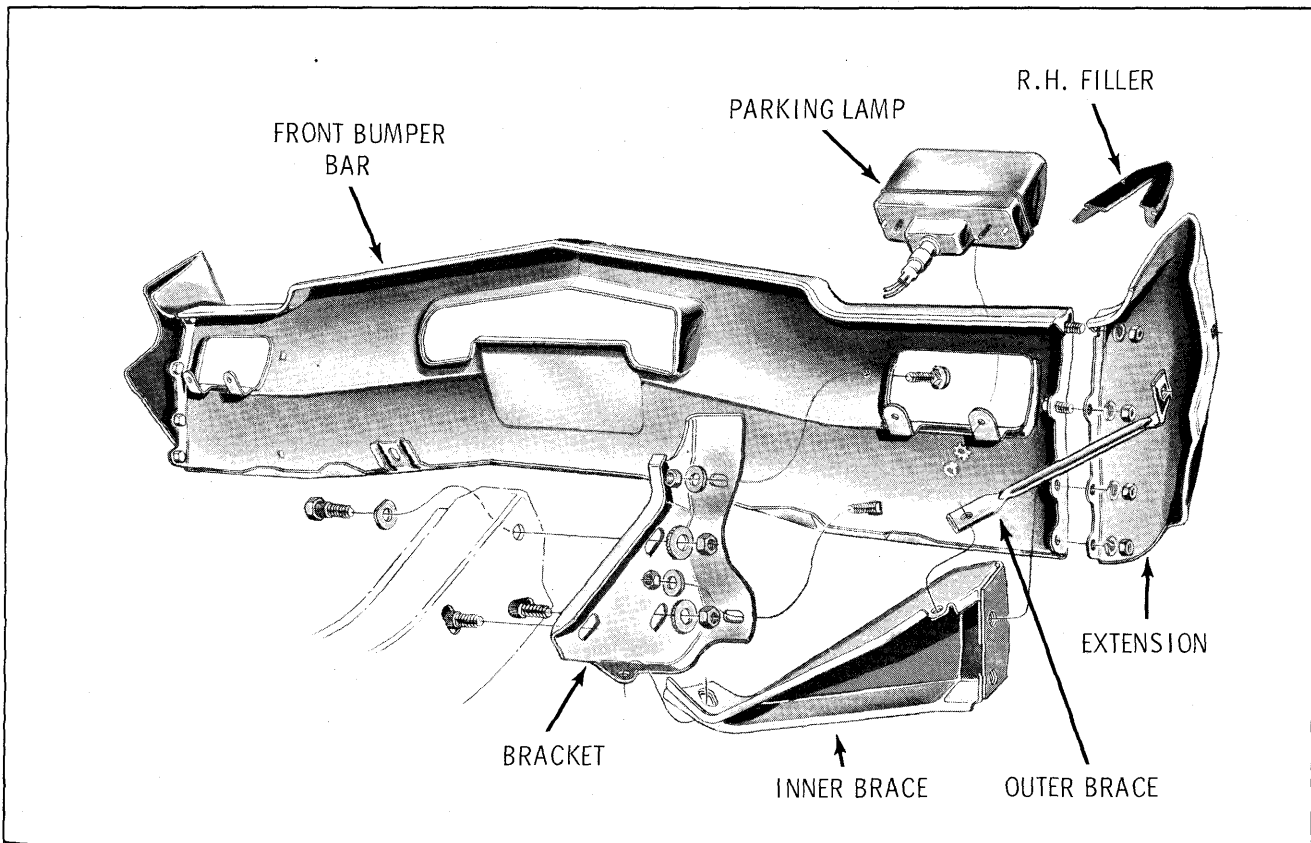

Fig. 14-1 Front Bumper - 52 through 86 Series

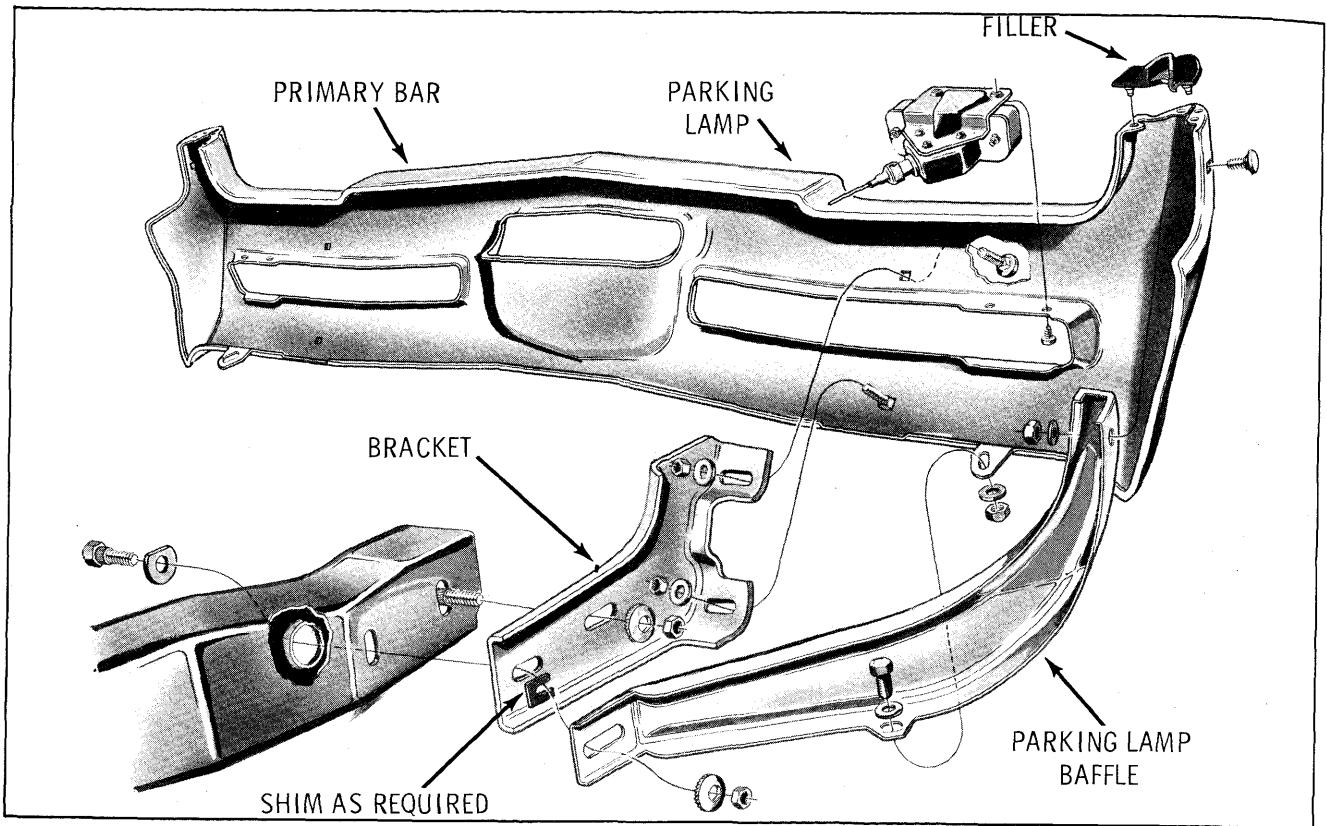

Fig. 14-2 Front Bumper - 33 through 38 Series

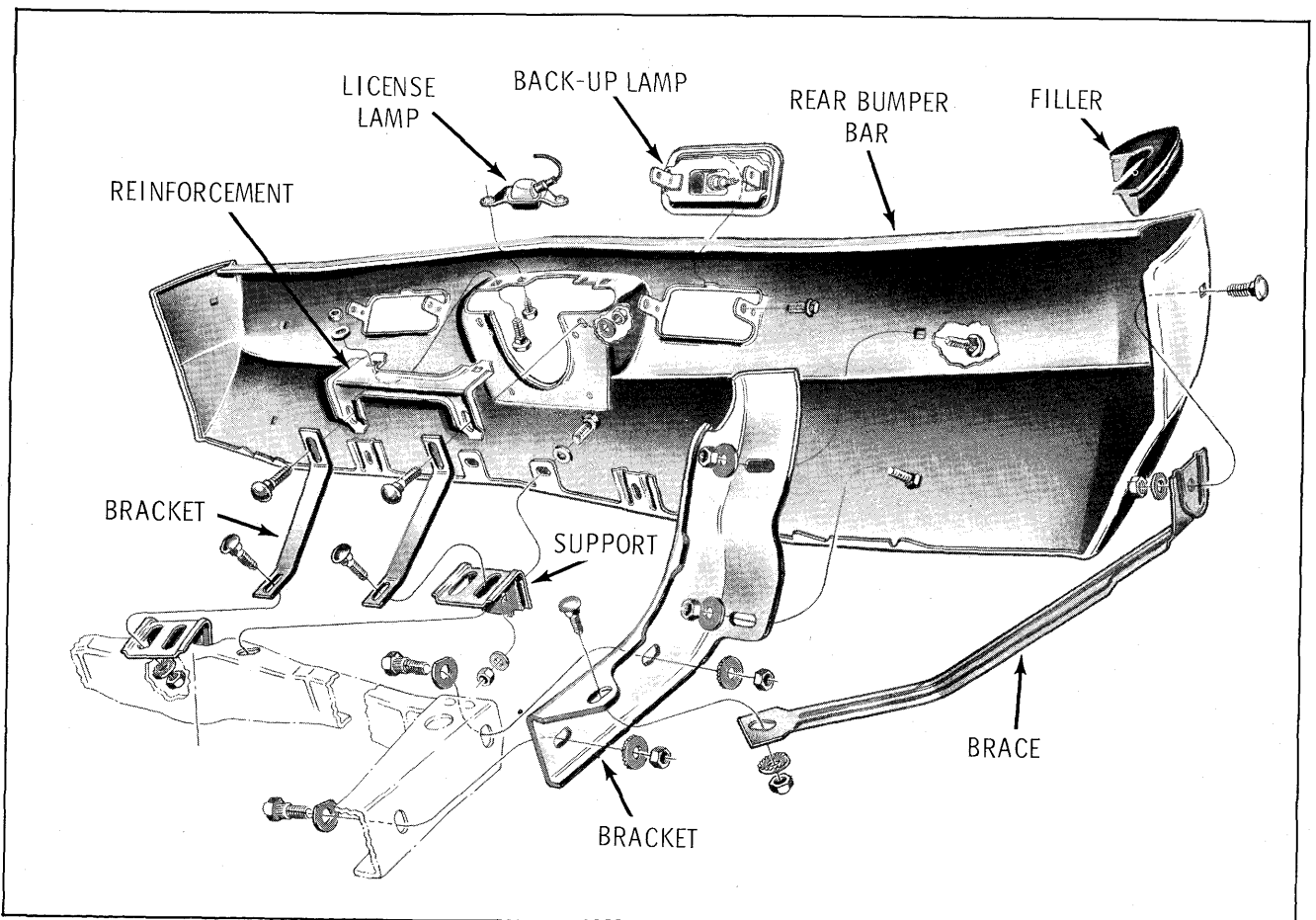

Fig. 14-3 Rear Bumper - 52, 54, 56 and 58 Series

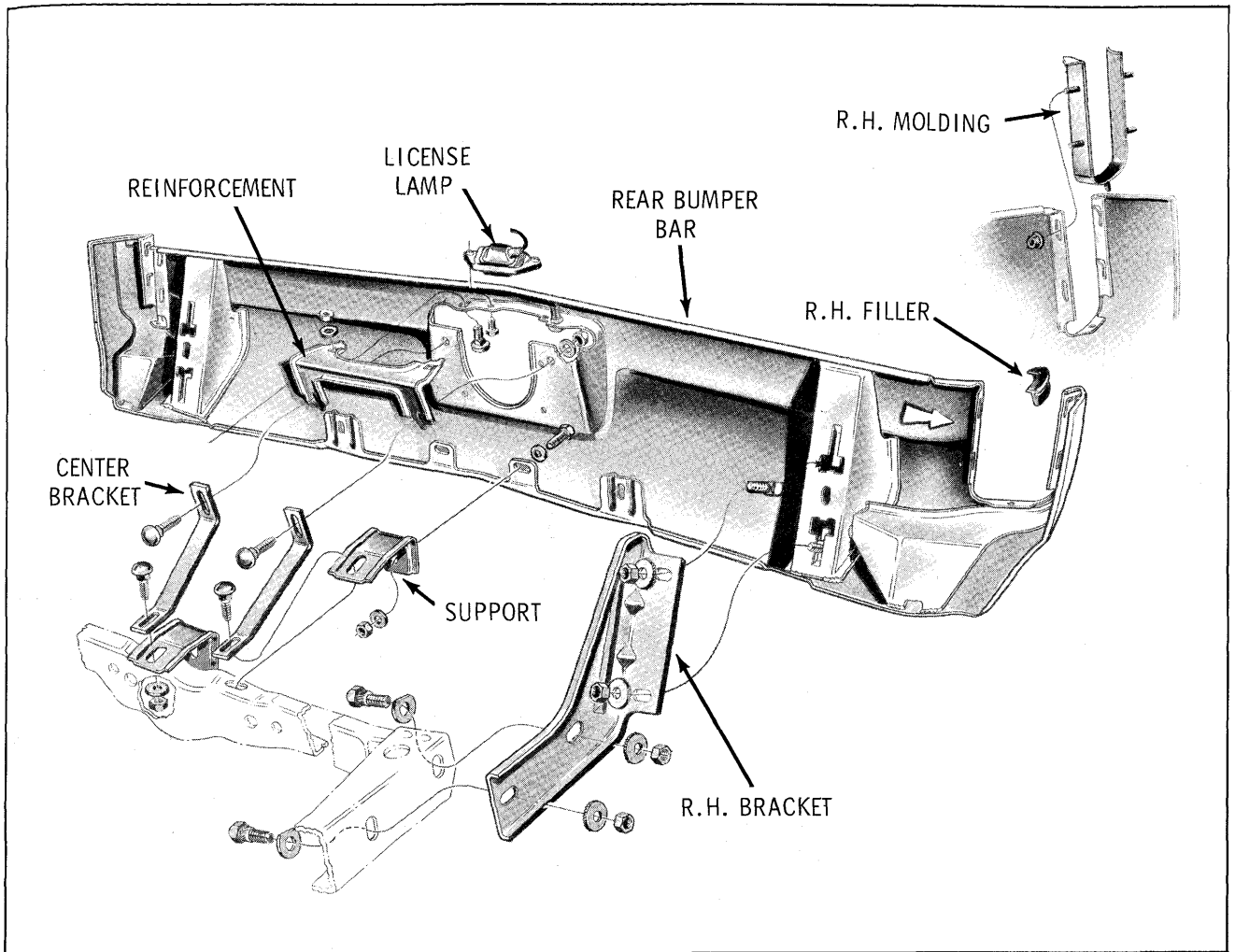

Fig. 14-4 Rear Bumper - 84 and 86 Series

PARKING LAMP ASSEMBLIES

The parking lamps can be removed without loosening or removing the bumpers. The parking lamp lens and bulb can be changed without removing the lamp assembly. For 33 through 38 Series, use Bulb No. 1157, for 52 through 86 Series, use Bulb No. 1157A.

REAR BUMPER

REMOVAL (Figs. 14-3, 14-4, 14-5 and 14-6)

52-86 Series

1. Disconnect back-up lamp and license lamp wiring.
2. Remove bolts securing bumper brackets to frame.
3. Remove bolts securing bumper to center supports.

4. Tip license plate down and remove bumper to bracket attaching bolts and remove bumper.

NOTE: Center supports and brackets remain attached to the frame crossmember.

33-38 Series

1. Disconnect back-up lamp and license lamp wiring.
2. Remove bracket to frame attaching bolts and remove bumper.

INSTALLATION (33-86 Series)

To install, reverse the removal procedure. Align the bumper horizontally and laterally so that bumper to body clearance is the same on both ends. The bumper brackets and frame bolt holes are elongated providing a means of alignment. Torque attaching bolts as indicated under TORQUE SPECIFICATIONS.

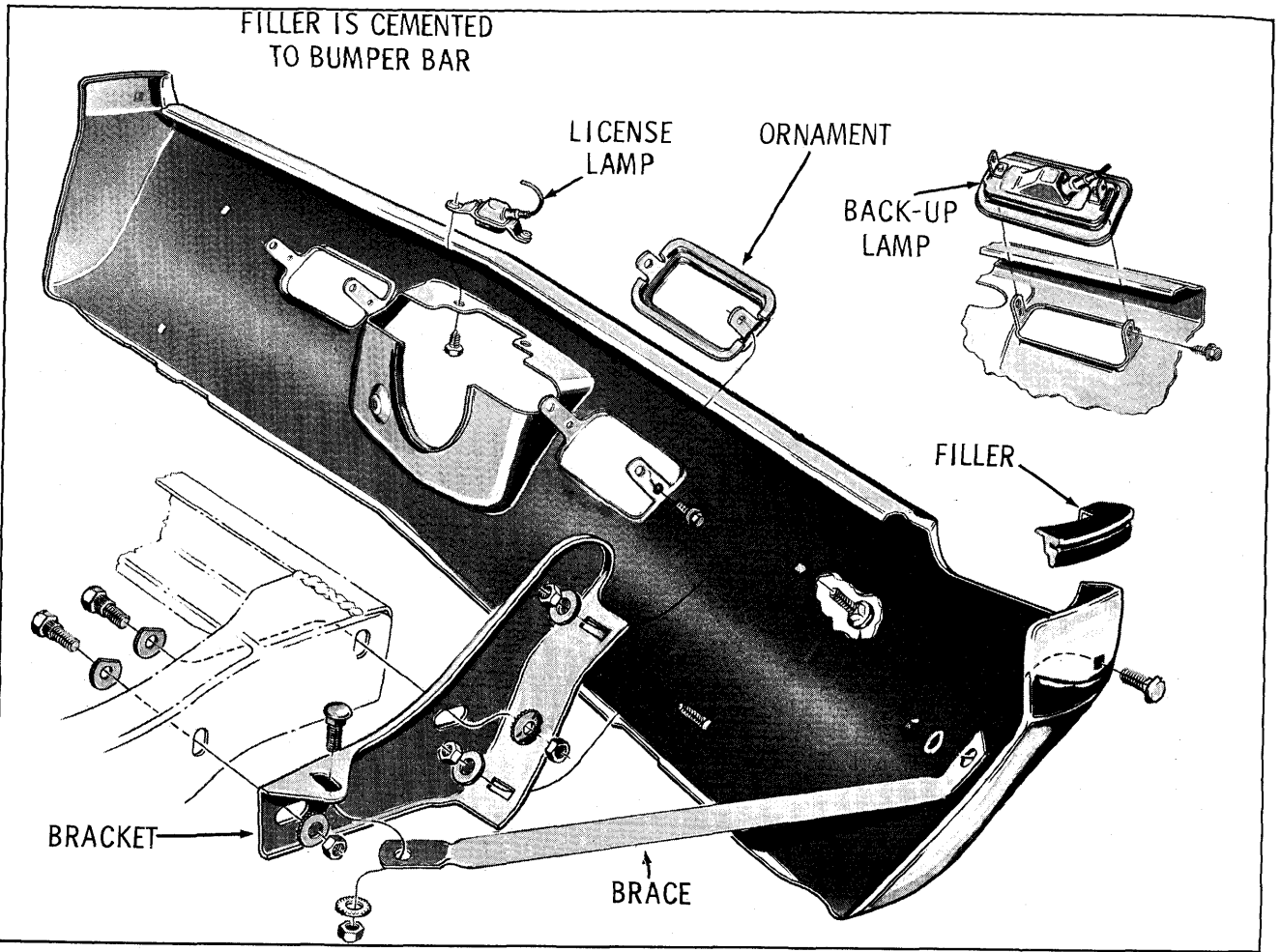

Fig. 14-5 Rear Bumper - 33 through 38 Series - Except Station Wagon

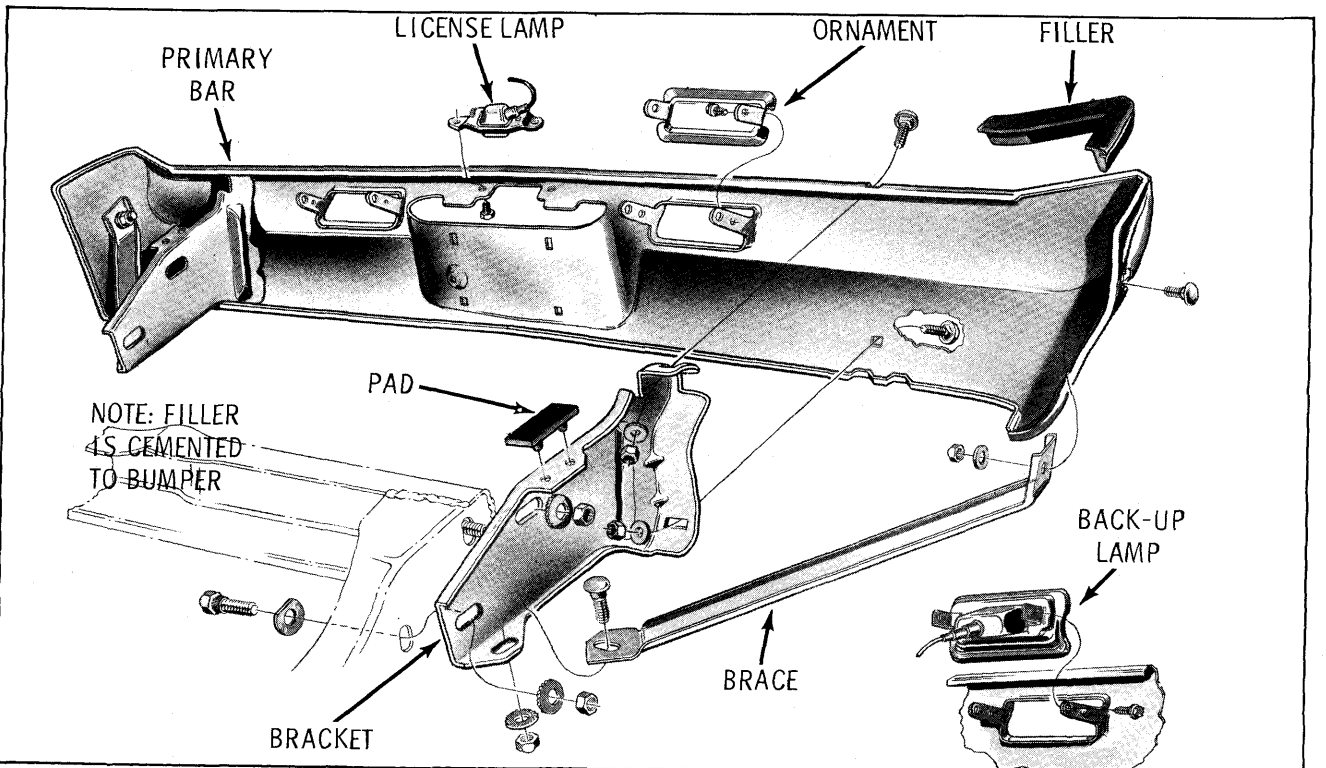

Fig. 14-6 Rear Bumper - 33 through 38 Series - Station Wagon Only

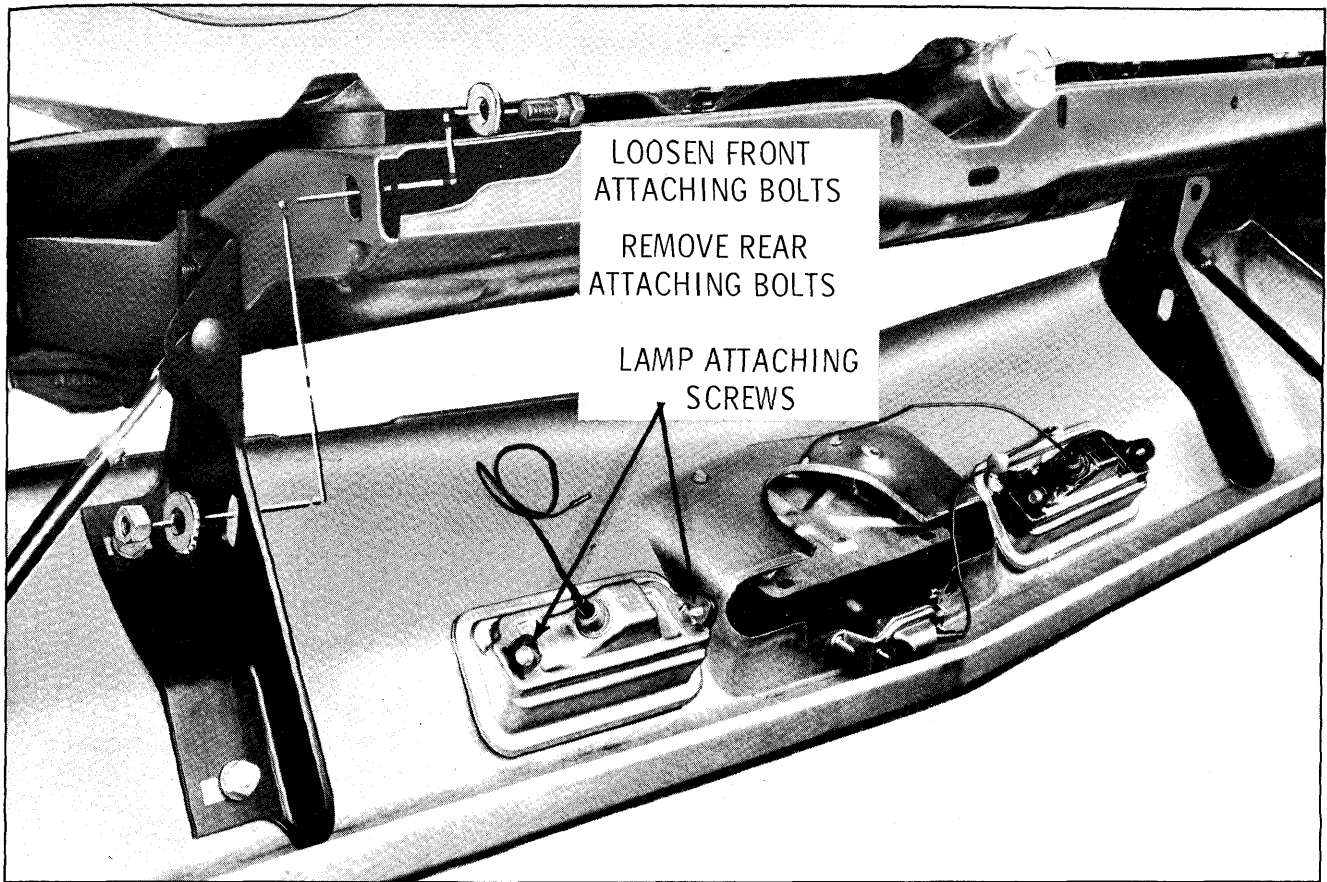

Fig. 14-7 Back-Up Lamp Removal - 33 through 38 Series

BUMPER MOLDING (84 & 86 Series)

Removal and Installation

It is not necessary to completely remove the bumper to remove the molding.

1. At center of bumper remove the bumper to support attaching bolts.

2. Tip license plate down and remove bumper to center bracket attaching bolts.

3. At the bumper bracket to frame attaching bolt location, remove the rear attaching bolts and loosen the front attaching bolt. The bumper will now pivot down. The molding attaching nuts are now accessible.

To install, reverse the removal procedure. Torque all attaching bolts as indicated under TORQUE SPECIFICATIONS.

BACK-UP LAMPS (33-58 Series)

For 33 through 38 (Fig. 14-7) - Disconnect wiring connections. Loosen the front bracket to frame attaching bolts and remove the rear attaching bolts allowing the bumper to pivot down. The lamp attaching bolts are now accessible. Use Bulb No. 1156.

Fig. 52 - 58 Series - Disconnect the wiring connectors. Loosen the bracket to frame attaching bolts and slide bumper rearward. The outboard lamp attaching bolts can be removed from the bottom and the inboard attaching bolt can be removed through the gas tank filler opening. Use Bulb No. 1156.

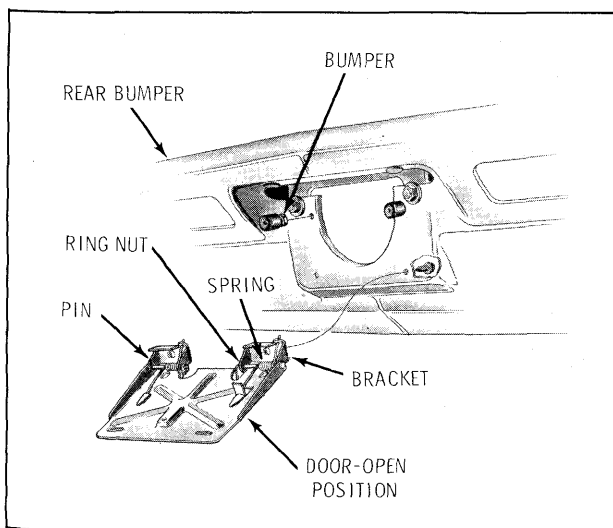

Fig. 14-8 Fuel Filler Door - 33 through 86 Series

FUEL FILLER DOOR (Fig. 14-8)

The fuel filler door can be removed by removing the hinge attaching screws from the rear side of the bumper through the filler opening. Torque bracket attaching bolts.

LICENSE LAMP, LENS OR BULB

The license lamp assembly, lens or bulb can be removed without loosening or removing the bumper. To remove the bulb, remove the lens and while pushing on the bulb, turn it counter-clockwise. For all series use Bulb No. 97.

TORQUE SPECIFICATIONS

NOTE: Specified torque is for installation of parts only. Checking of torque during inspection may be 10% below that specified.

APPLICATION	FT. LBS.
Front Bumper	
Fuel Filler Door Bracket to Bumper Attaching Bolts	8
Bumper Bracket to Frame Attaching Bolts	70
Parking Lamp Baffle to Bumper Attaching Bolt (33-38 Series)	40
Bumper to Bracket Attaching Bolts	70
Rear Bumper	
Bumper to Brace Attaching Bolts	40
Ornament Attaching Screws	5
Bumper Extension to Primary Bar (52-86 Series)	40
Back-Up Lamp Attaching Nuts	8
Reinforcement to Bumper Attaching Bolts	40